

M/PTOL6.1

KNX Tile Series Climate Panel

Hardware Version: B

Product Name	Panel & Frame	Model No.
KNX Tile Series Climate Panel (Plastic & metal versions)	Tile Series Climate Panel	M/PTOL6.1



Datasheet

Issued: June 8, 2021

File Edition: C



Figure 1. KNX Tile Series Climate Panel

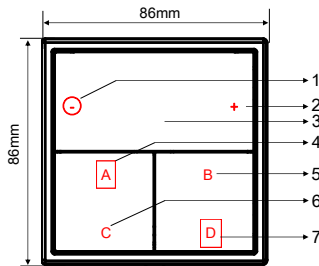

Figure 2. Dimensions - Plastic version

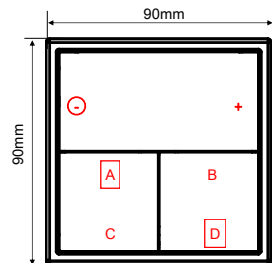

Figure 3. Dimensions - Metal version



Figure 4. Dimensions - Side View

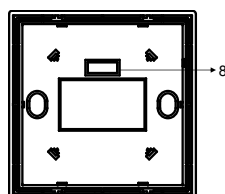

Figure 5. Components - Back View

## Overview

KNX Tile Series Climate Panel (See Figure 1) is divided into a LCD display and four pushbuttons, enabling controls of air conditioning, floor heating and ventilation system. Parameters can be set by ETS or manually set on the panel. The brightness level can be set. The icons and text on the panel support laser labelling.

Its functions include:

- Built-in temperature and humidity sensor
- Built-in proximity sensor, when the panel detects human body, the LCD screen backlight and button lights can be lit.
- Adjustable LCD backlight brightness
- Different pages for air conditioning, floor heating and ventilation system, and each can be used to control 1 channel device.
- Icons and text support laser labelling
- Enables controls and settings: Page switching, Air conditioner on/off, Air conditioner mode setting, Air conditioner temperature setting, Air conditioner fan speed setting, Static display of ambient temperature & humidity, Floor heating on/off, Floor heating temperature and mode setting, Ventilation on/off, Ventilation fan speed setting, Ventilation mode setting, Backlight brightness setting
- Supports online upgrade

## Components and Operation

Dimensions - See Figure 2 - 4

Components - See Figure 5

1. "-" Button: Decrease the set temperature or screen backlight brightness.
2. "+" Button: Increase the set temperature or screen backlight brightness.
3. LCD display: Displays information such as icons and status.
4. Page switching button: Used to switch pages among air conditioning page, floor heating page and ventilation page.
5. Return button & Mode switching button: Used to return to the main interface page and switch modes of air conditioning, floor heating and ventilation.
6. On/Off button: Switch on/off of air conditioning, floor heating and ventilation system.
7. Fan speed button: Used to switch fan speed of air conditioning and floor heating.
8. Communication interface

### Operation

Screen backlight brightness setting: Press Button C and D simultaneously for about 2 seconds to enter the screen backlight brightness setting interface, and press Button B to save the brightness value and return to the main interface.

Programming mode: Press Button A and D (See Figure 2&3) simultaneously for 2 seconds and then the panel will enter programming mode.

Upgrade mode: Keep pressing Button A and + simultaneously before powered on (See Figure 2&3), release the buttons after being powered on for 2s, then the panel will enter upgrade mode.

## Important Notes

- The panel must be wall box installation.
- The panel must work in conjunction with KNX Tile Series Panel Power Interface (with External Power Supply) (M/PTCI2P.1).
- The device is compliant with the KNX standard and the parameters are set by the Engineering Tool Software (ETS).

## Safety Precautions

- The installation and testing for the product must be carried out by HDL Automation Co., Ltd. or its appointed service agencies. The electric construction shall comply with local laws and safety regulations.
- HDL will not be responsible for any consequence caused by the inexpert or faulty installation and wiring methods, which are not in accordance with the instructions contained in this operating instruction.
- Please do not privately disassemble or replace any parts of the product. Otherwise, it may cause mechanical fault, electric shock, fire or personal injuries.
- Please contact our after-sales departments or our designated service agencies for your maintenance service. Product failures caused by private disassembly are not subject to this warranty.

## Package Contents

M/PTOL6.1\*1 / Datasheet\*1

## Technical Data

### Basic Parameters

Working voltage	21~30V DC
Working current	15mA/30V DC
Auxiliary voltage	20~30V DC
Auxiliary current	18mA/24V DC
Communication	KNX
Cable diameter of KNX terminal	0.6 - 0.8mm

### External Environment

Working temperature	-5°C~45°C
Working relative humidity	≤90%
Storage temperature	-20°C~60°C
Storage relative humidity	≤93%

### Specifications

Dimensions	Plastic version: 86×86×11(mm) Metal version: 90×90×11(mm)
Net weight	Plastic version: 75g Metal version: 113g
Housing material	Plastic version: Flame retardant PC Metal version: Aluminum alloy
Installation	Wall box (See Figure 6)
Protection rating (Compliant with EN 60529)	IP20

### Approved

CE, RoHS

KNX

### KNX Cable Guide

KNX	KNX Cable
-	Black
+	Red

### Installation

#### Installation - See Figure 6

- Step 1. Install the wall box in the wall.
- Step 2. Secure the power interface to the wall box with screws.
- Step 3. Install the panel on the power interface.
- Step 4. Install the frame around the panel.

#### Horizontal installation - See Figure 7

#### Vertical installation - See Figure 8

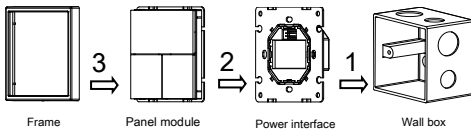

Figure 6. Installation

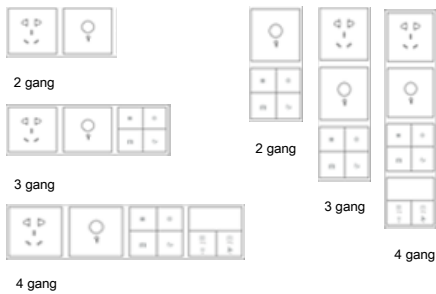

Figure 7. Horizontal installation

Figure 8. Vertical installation

Notes: Metal panels can be installed either horizontally or vertically. Plastic panels can be only installed horizontally.

Product Name	Frame Types	Gang	Dimensions
2/3/4-gang frames	Metal	2 gang	176*90*11(mm)
		3 gang	262*90*11(mm)
		4 gang	348*90*11(mm)
	Plastic	2 gang	172*86*11(mm)
		3 gang	258*86*11(mm)
		4 gang	344*86*11(mm)

#### Technical support

E-mail: [hdltickets@hdlautomation.com](mailto:hdltickets@hdlautomation.com)

Website: <https://www.hdlautomation.com>

©Copyright by HDL Automation Co., Ltd. All rights reserved.  
Specifications subject to change without notice.